



1 Comic Court NEW GISBORNE VIC

3 1 2

Delightful compact residence located within easy walk to the station, primary schools, parks and Tavern. Accommodation comprises three bedrooms, ensuite, large living area that includes kitchen/meals and living space. Integrated double garage has direct access into the home. A quiet position that is sure to be attractive to many home buyers!

Type : House
Building Size : 17 sqm
Land Size : 844 sqm
View : <https://www.kennedyandhunt.com.au/sale/vic/macedon-ranges/new-gisborne/residential/house/5848405>

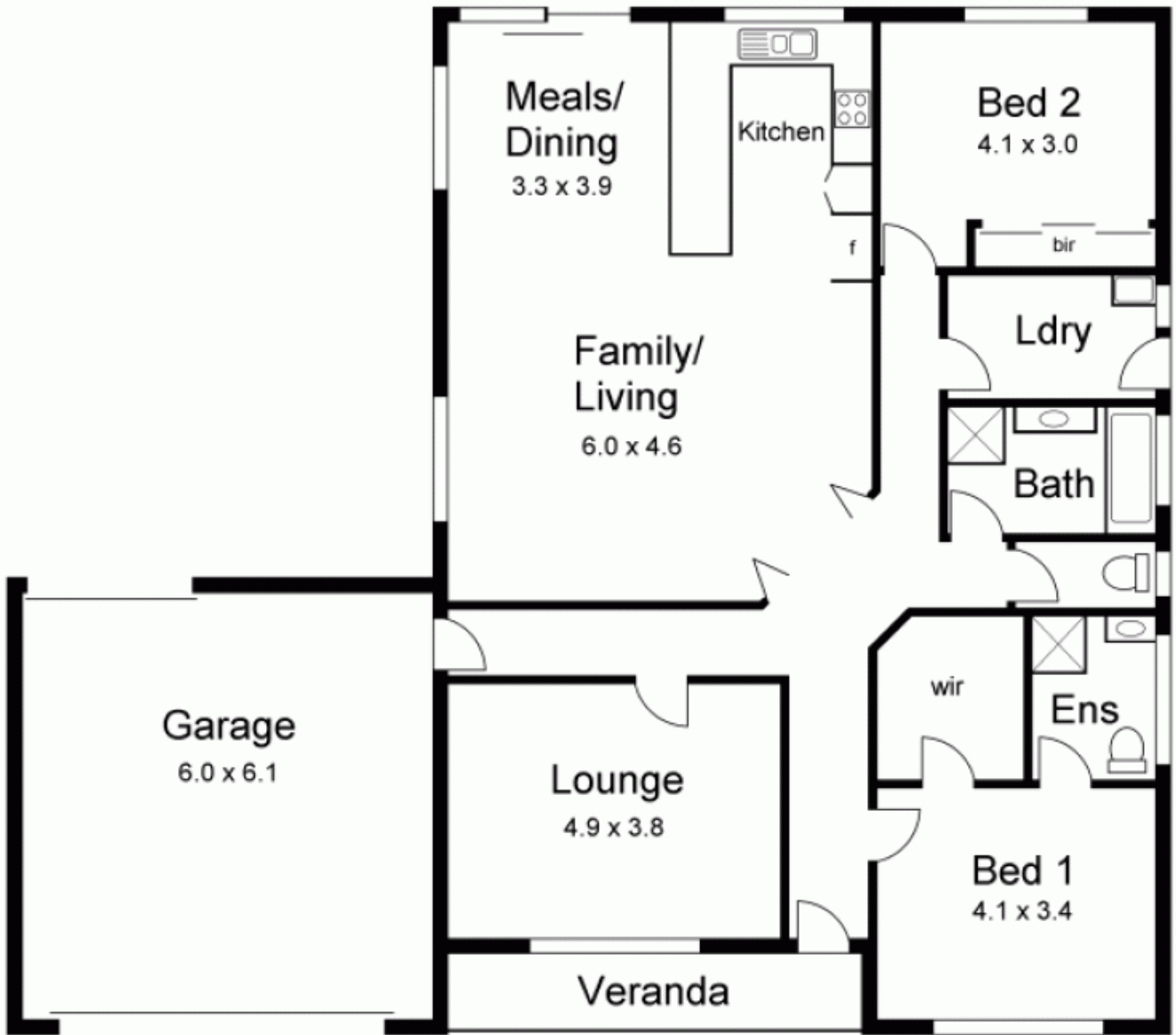

All measurements are approximate