



**52 Andrew Avenue WOODEND VIC**

3 2 2

Space and privacy within easy strolling distance of the centre of town and all facilities. Level block with stand of mature native trees screening the brick veneer home. Practical floor plan offers three double bedrooms with good storage space, parents retreat, light and airy kitchen/meals area, L shaped lounge/dining room, ensuite and main bathroom. Includes double garage and large steel shed. Further development or enjoy as is.

**Building Size** : 17 sqm  
**Land Size** : 10000 sqm  
**View** : <https://www.kennedyandhunt.com.au/sale/vic/greater-bendigo-region/woodend/residential/house/5848422>

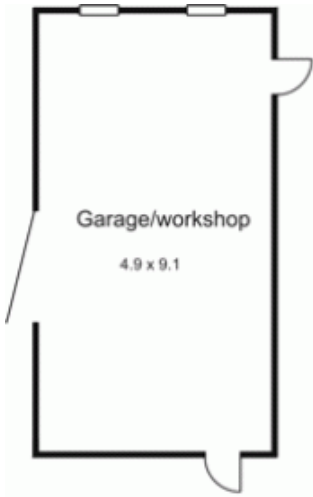

Outbuildings not in actual position to house.

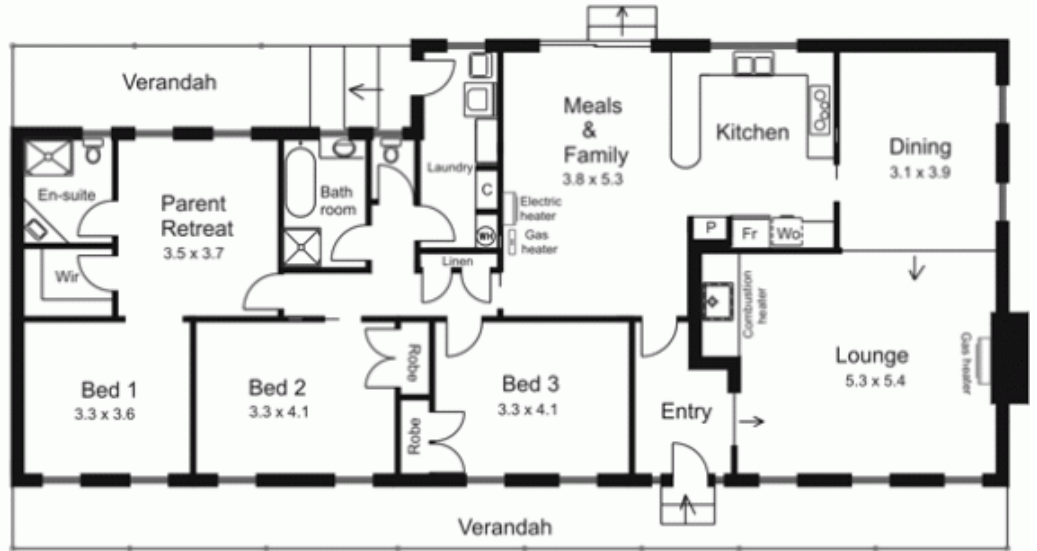
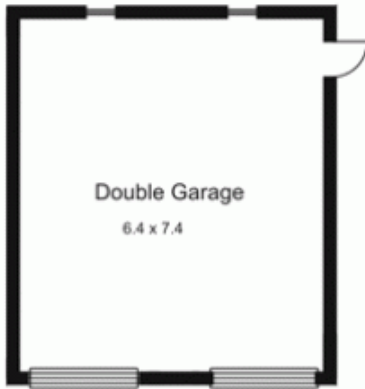

All measurements are approximate only.  
Not drawn to scale.