



16 Kiwi Court NEW GISBORNE VIC

3 2 2

LAND APPROX. 950m - CORNER LOCATION

Fun for the whole family. Home comprises 3 large bedrooms, built-in & walk-in robes, study, ensuite & family bathroom. Wide hallways, lounge & diningroom. Kitchen with as new appliances, familyroom with direct access to pergola. Evaporative cooling, double garage, natural gas connected.

Type : House
Building Size : 20 sqm
Land Size : 950 sqm
View : <https://www.kennedyandhunt.com.au/sale/vic/macedon-ranges/new-gisborne/residential/house/5848427>

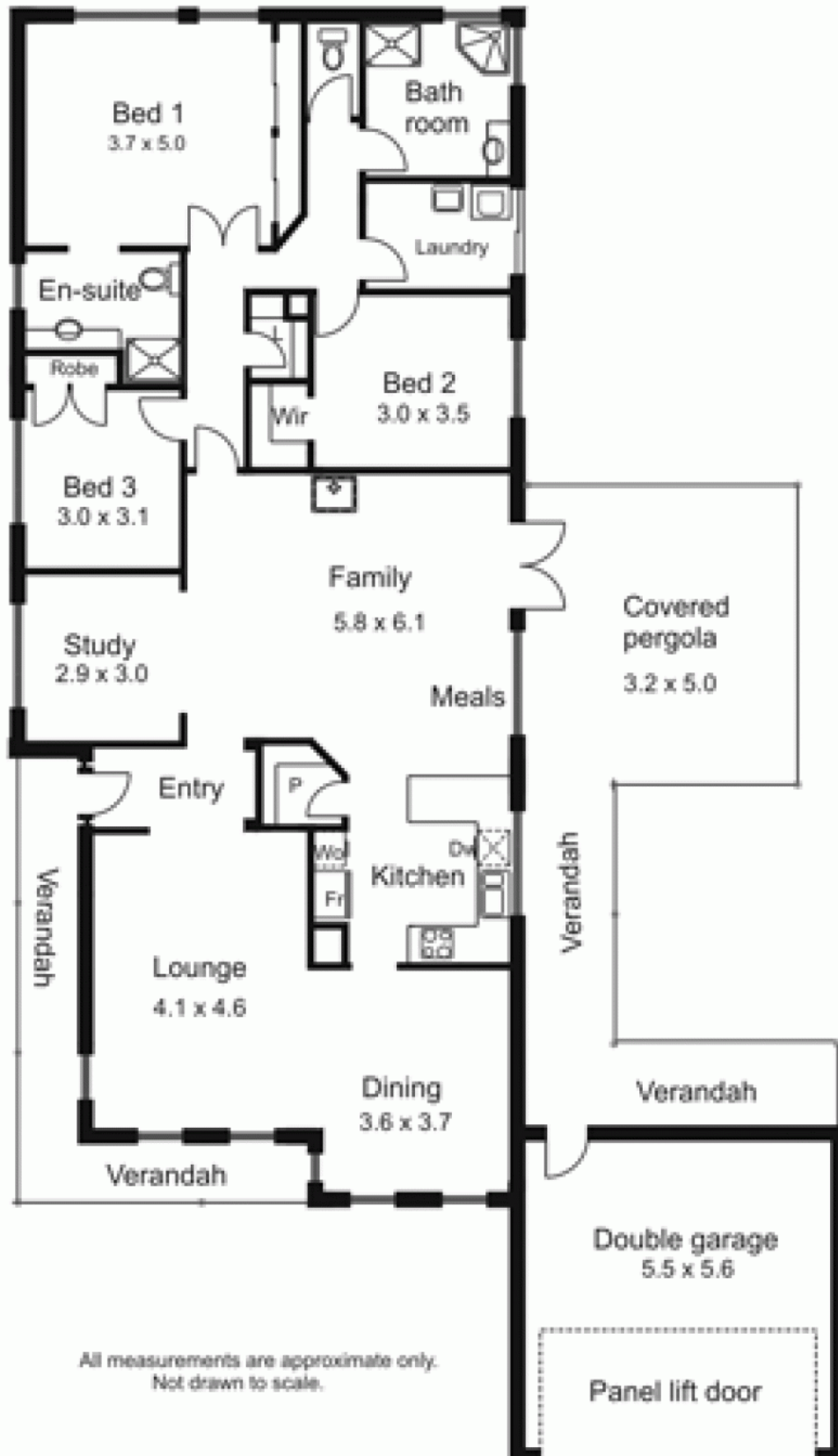

All measurements are approximate only.
Not drawn to scale.