



9 Skyline Drive GISBORNE VIC

4 2 2

Four bedroom home offering quality & space for the growing family. Includes enormous formal living room with open fire place, rumpus room & meals area with direct access to superb outdoor entertainment space. Two smart bathrooms, natural gas central heating. Double integrated garage & separate shed approx 9.7m x 12m.

Building Size : 25 sqm
Land Size : 2000 sqm
View : <https://www.kennedyandhunt.com.au/sale/vic/macedon-ranges/gisborne/residential/house/5848458>

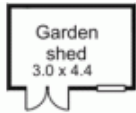

Outbuildings not in actual position or orientation to house.

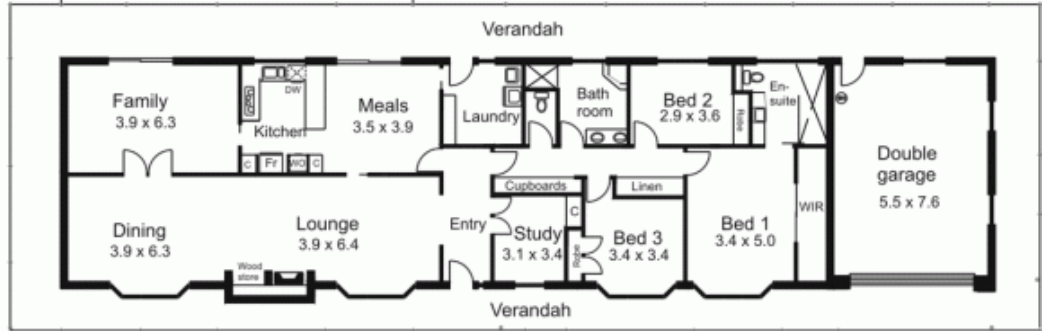
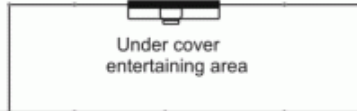

All measurements are approximate only. Not drawn to scale.