



9 Peavey Road GISBORNE VIC

4 2 4

Comprises 3 living areas, 4 bedrooms, 2 bathrooms. Neutral tonings. Features high ceilings, quality kitchen, reverse cycle air conditioning and cosy wood heating. Includes magnificent outdoor living area, double garage work shop and carport. Beautiful mature gardens ready to enjoy!

Building Size : 25 sqm
Land Size : 7160 sqm
View : <https://www.kennedyandhunt.com.au/sale/vic/macedon-ranges/gisborne/residential/house/5848496>

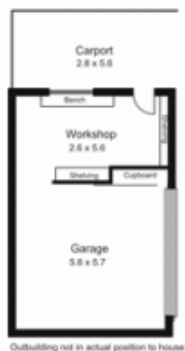

Outbuilding not in actual position to house

