



**2/22 Howey Street GISBORNE VIC**

2 1 1

Nestled privately at the rear of the property this unit is sure to impress. Two bedrooms, large living area and house sized kitchen with stainless steel appliances compliment an extremely effective floor plan. North facing living opening to fantastic outdoor living area. Natural gas heating and air conditioner. Single garage. Large garden area along sides and rear. Ideal retirement home, first home or smart investment.

**Type** : Unit  
**Building Size** : 11 sqm  
**Land Size** : 755 sqm  
**View** : <https://www.kennedyandhunt.com.au/sale/vic/macedon-ranges/gisborne/residential/unit/5848515>

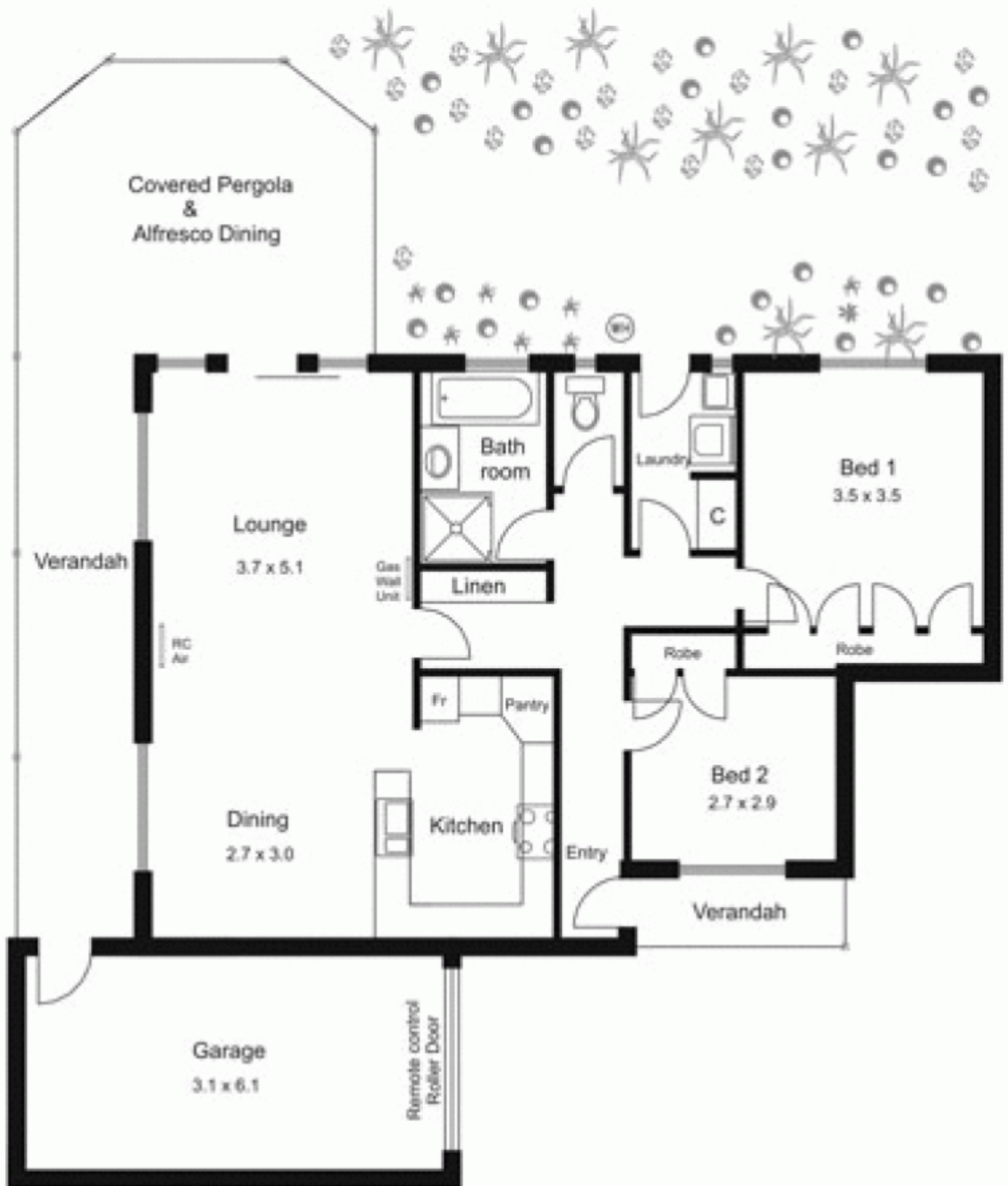

Drawing is for illustration purposes only. Not drawn to scale. All measurements are approximate only.