



**147 Panorama Drive GISBORNE VIC**

4 2 2

Impressive renovation emphasizes quality and style. Accommodation comprises four bedrooms, open plan central kitchen/meals/living space and separate formal step down lounge. Northern orientation overlooks the spectacular view, pool and manicured gardens. A distinctly different offering, be ready to be impressed!

**Type** : House  
**Building Size** : 21 sqm  
**Land Size** : 5403 sqm  
**View** : <https://www.kennedyandhunt.com.au/sale/vic/macedon-ranges/gisborne/residential/house/5848516>



Pool not in actual position to house.

- Legend  
 RWT\_rain water tank  
 C\_cupboard  
 L\_linen  
 Dw\_dishwasher  
 Fr\_Fridge  
 P\_Pantry



2 x 9,000 Litres

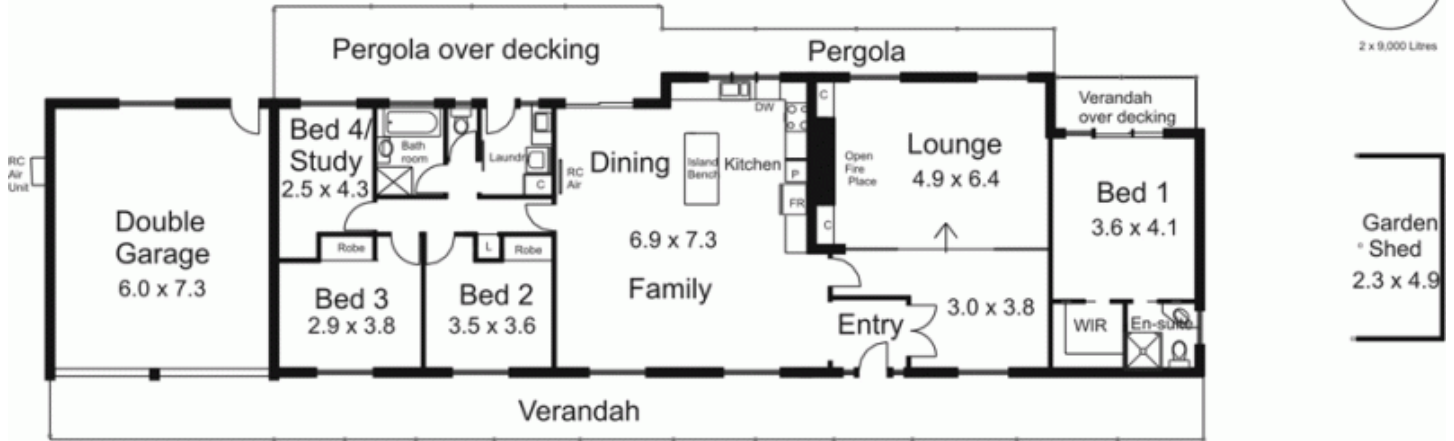

Drawing is for illustration purposes only. Not drawn to scale. All measurements are approximate only.