



21 Clarke Street MOUNT MACEDON VIC

4 3 2

Private and versatile corner allotment enhances usability and visual amenity. Accommodation comprises four bedrooms, lounge, dining, family room, kitchen/meals area and sunroom. Features include timber highlights, step down lounge with fireplace, exceptional garden views from all rooms, bore and pump, water tank and good shedding. All services are available. Take the time to inspect and be delighted!

Fell free to attend an open house or call us to inspect by appointment.

Type : House
Building Size : 24 sqm
Land Size : 4047 sqm
View : <https://www.kennedyandhunt.com.au/sale/vic/macedon-ranges/mount-macedon/residential/house/5848518>

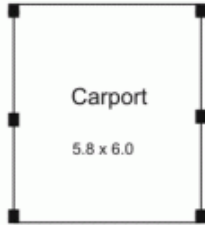
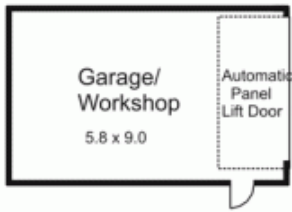

Legend...
 DW...dishwasher
 C...cupboard
 L...linen
 OFF...open fire place
 HW...hot water system
 F...fridge
 WO...wall oven

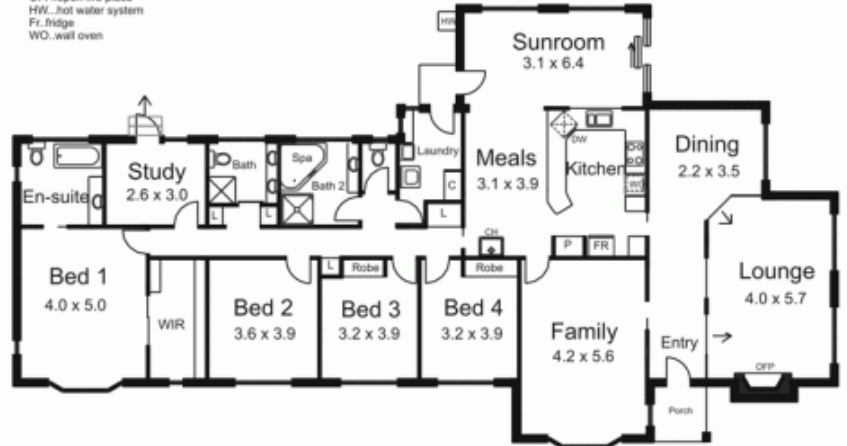

Drawing is for illustration purposes only. Not drawn to scale. All measurements are approximate only.