



3 Pinelea Grove GISBORNE VIC

4 2 2

Great design with wide entry, 4 bedrooms, full ensuite, rumpus/lounge and fantastic kitchen/dining/family area opening to sheltered pergola and pool area. Incl. ducted cooling/heating, granite bench tops, 2.7 m ceilings/decorative cornice and much more. Fully paved and landscaped garden. Move in and start living!

Type : House
Land Size : 1001 sqm
View : <https://www.kennedyandhunt.com.au/sale/vic/macedon-ranges/gisborne/residential/house/5848519>

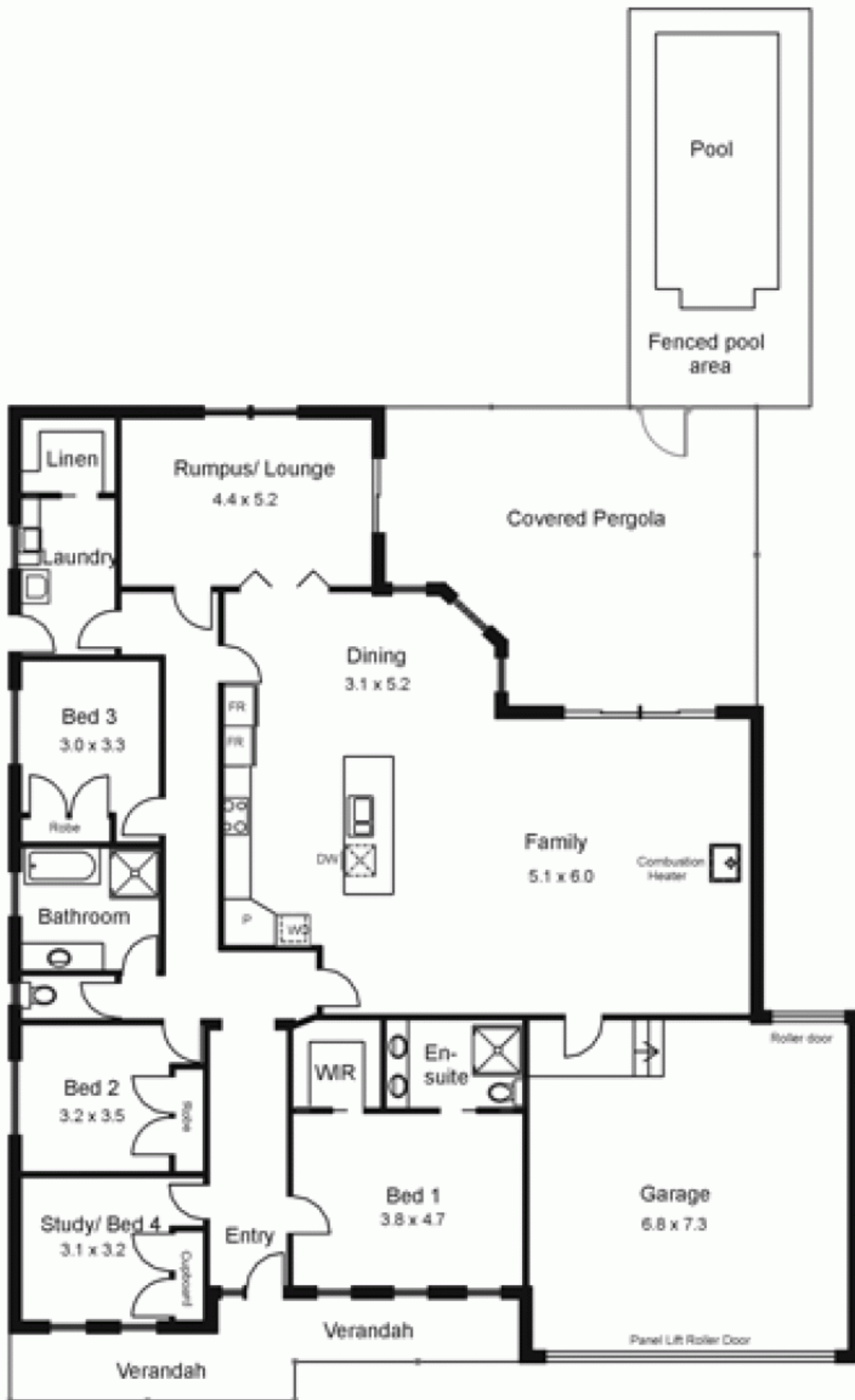

Drawing is for illustration purposes only. Not drawn to scale. All measurements are approximate only.