



48 Glen Echo Court MOUNT MACEDON VIC

3 2 4

LIGHT FILLED ARCHITECT DESIGNED SPLIT LEVEL RESIDENCE.
SERENE MOUNTAIN SETTING WITH MAGNIFICENT VIEWS.

Winding paths explore European & native plantings under Eucalypt canopy. Contemporary living with numerous decks and balconies, open plan living, 3 bedrooms, study nook, ensuite & powder room, basement workshop/studio. Features open fire place & 'brush box' flooring. Tennis court. An exciting concept!

Type : Acreage/Semi-Rural
Building Size : 25 sqm
Land Size : 43000 sqm
View : <https://www.kennedyandhunt.com.au/sale/vic/macedon-ranges/mount-macedon/residential/acreagesemirural/5848535>

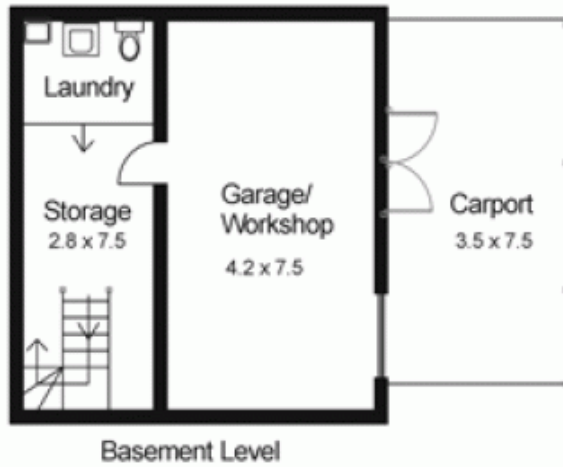
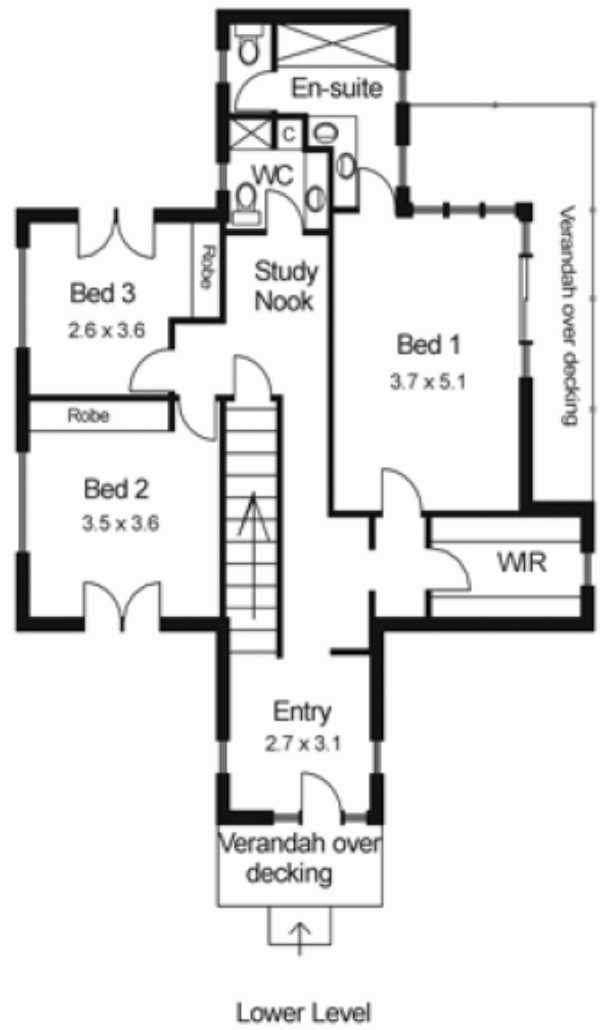
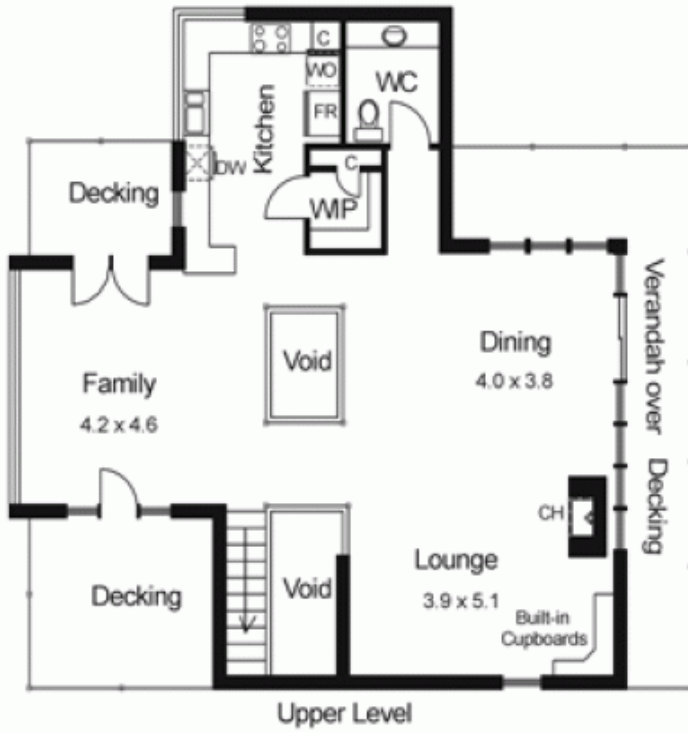

Drawing is for illustration purposes only. Not drawn to scale. All measurements are approximate only.