



**9 Williams Lane RIDDELLS CREEK VIC**

3 2 4

Great floor plan with up to 4 living areas (including home theatre), 3/4 bedrooms, study and full ensuite. Features zoned reverse cycle air conditioning, well appointed kitchen & outdoor living. Concrete steel dog runs, tanks & town water. Natural gas available. Convenient to Gisborne & Riddells Creek. Superb view to Macedon Ranges.

**Type** : Acreage/Semi-Rural  
**Building Size** : 24 sqm  
**Land Size** : 15720 sqm  
**View** : <https://www.kennedyandhunt.com.au/sale/vic/macedon-ranges/riddells-creek/residential/acreagesemirural/5848549>

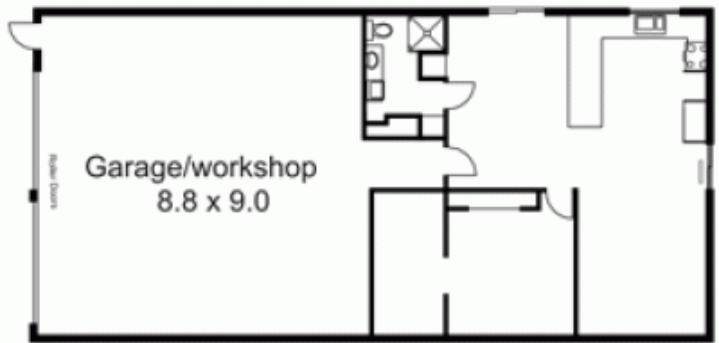

Outbuilding not in actual position to house.

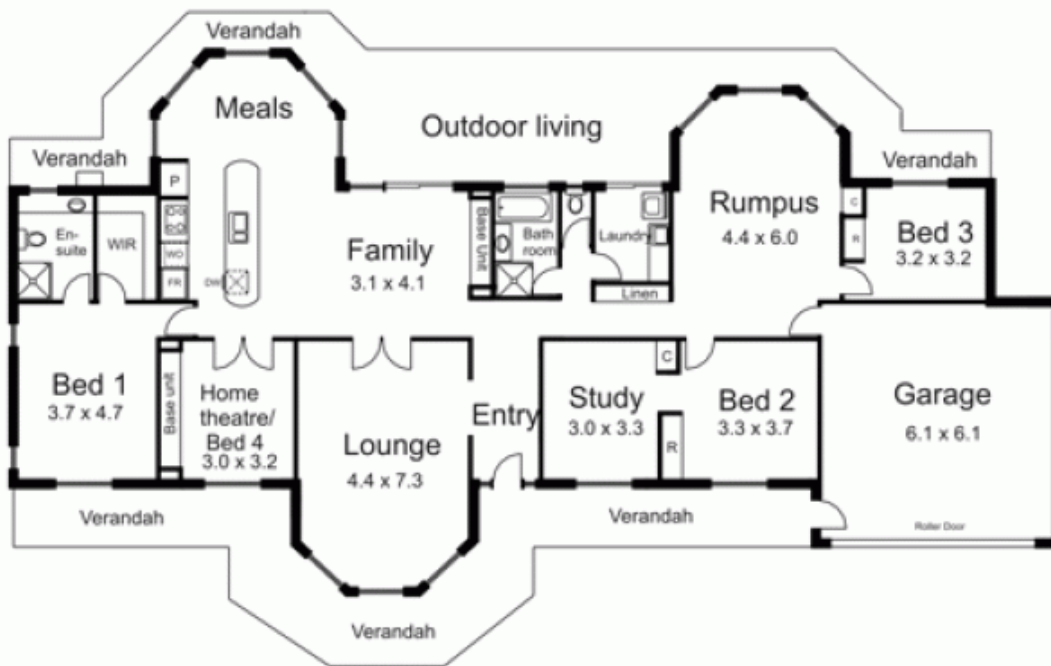

Drawing is for illustration purposes only. Not drawn to scale. All measurements are approximate only. Neither the Vendor or the Agent or Staff to Staff Outlines are responsible for any errors or omissions. It is up to the purchaser to verify all information.