





19 Melbourne Road GISBORNE VIC

3  1  4 

**Type** : House  
**Building Size** : 16 sqm  
**Land Size** : 4660 sqm  
**View** : <https://www.kennedyandhunt.com.au/sale/vic/macedon-ranges/gisborne/residential/house/5848552>

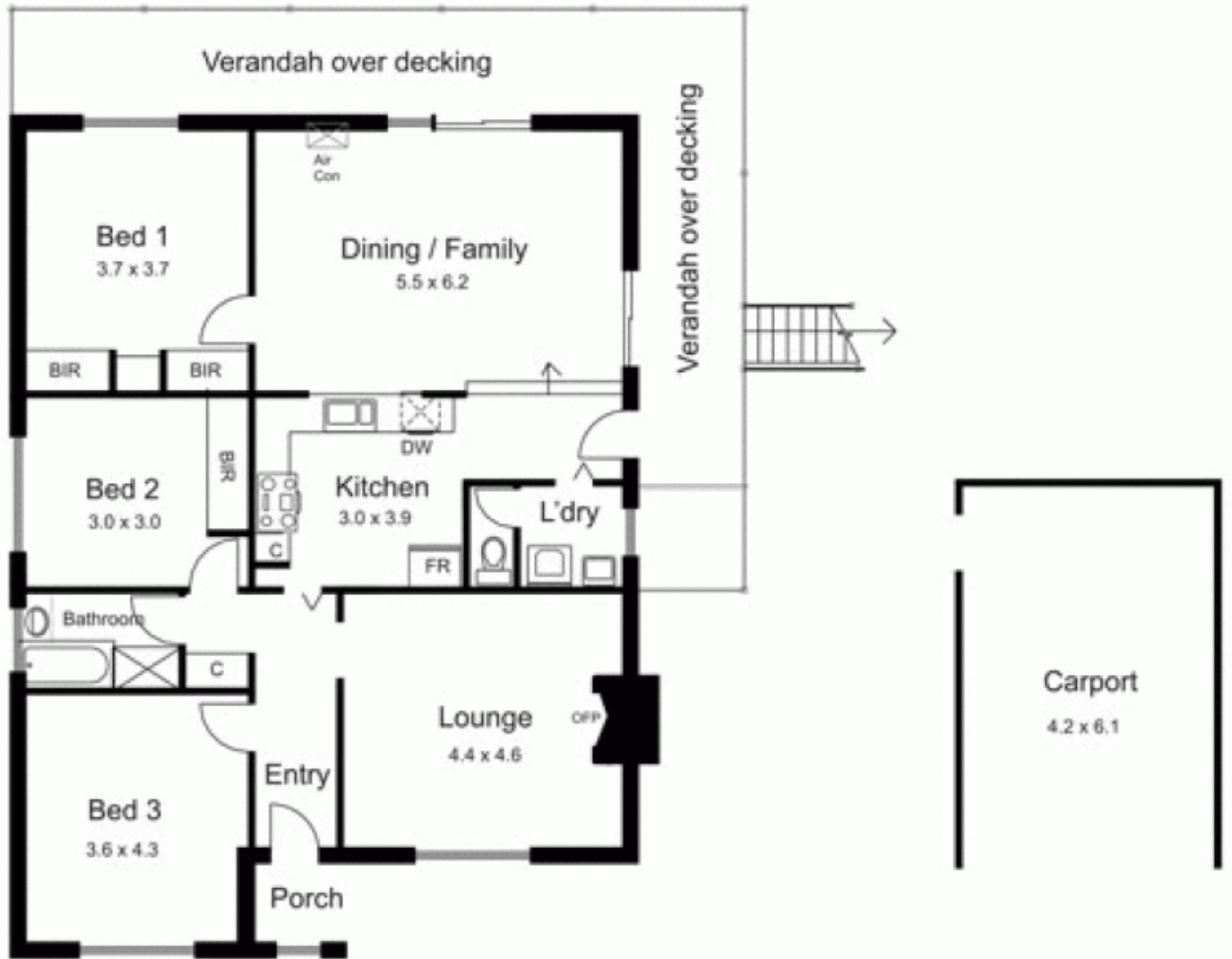

Drawing is for illustration purposes only. Not drawn to scale. All measurements are approximate only.