



2 Rimfire Court NEW GISBORNE VIC

3 2 2

Attractive home offering three bedrooms plus study, lounge, large open plan kitchen/meals/living area, ensuite, bathroom & laundry. Fresh colour scheme throughout, loads of storage, natural gas central heating, evap.cooling, dishwasher, water tank and much more. Integrated double garage, huge undercover outdoor area, and separate workshop with concrete floor and power. Private, landscaped and well established gardens. Nothing to do everything to enjoy!

Everyone will find this property appealing.

Type : House
Building Size : 18 sqm
Land Size : 1000 sqm
View : <https://www.kennedyandhunt.com.au/sale/vic/macedon-ranges/new-gisborne/residential/house/5848607>



Garden Shed not in actual position to house

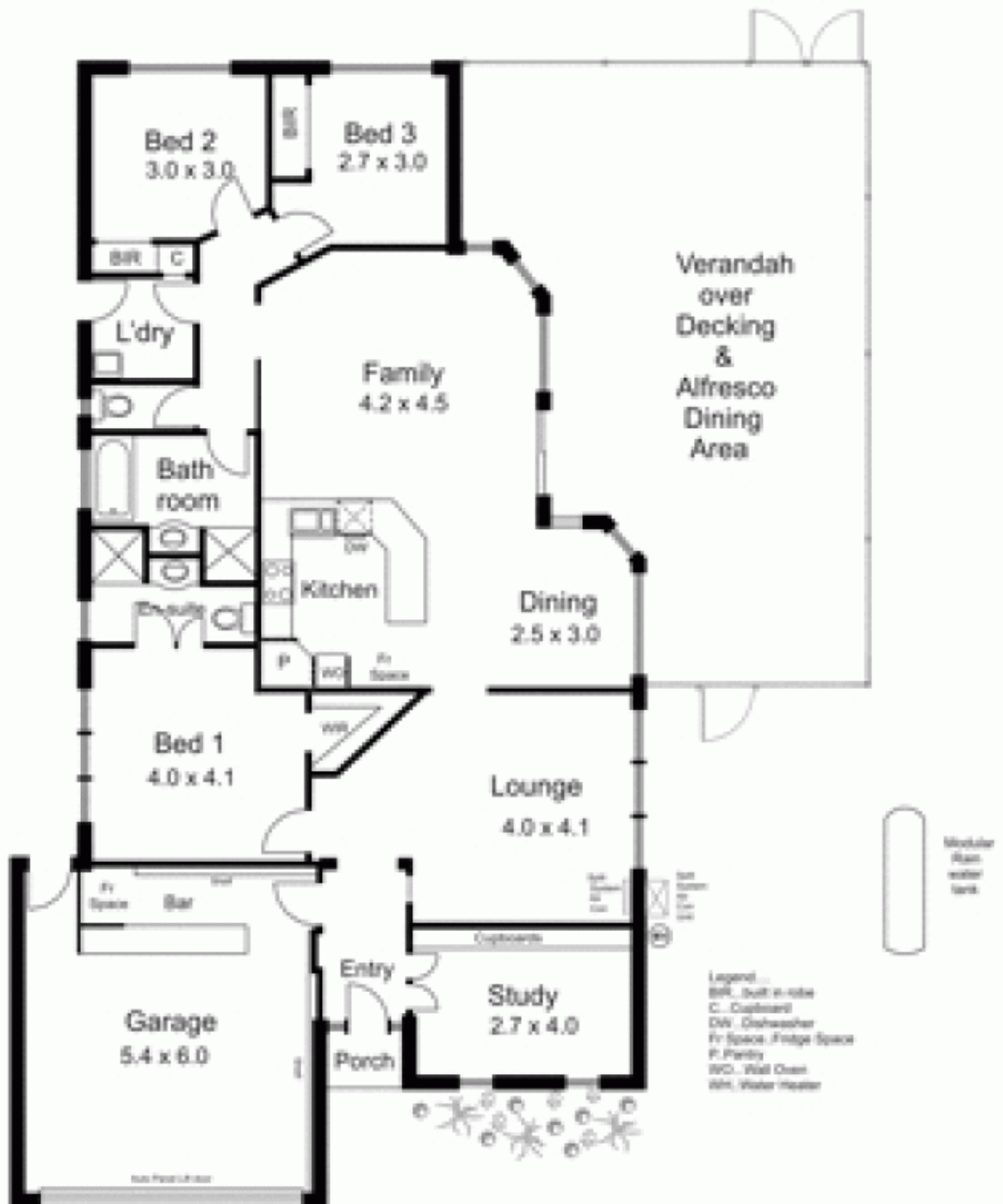

Drawing is for illustration purposes only. Not drawn to scale. All measurements are approximate only.