



**83 Mount Gisborne Road GISBORNE VIC**

3 2 5

Established lifestyle property enhanced by an expansive outlook over Gisborne and on to Mount Macedon. The home comprises three bedrooms, study, fantastic central open plan area incorporating kitchen/meals, family, lounge and entry foyer. Fabulous vaulted ceilings accentuate the feeling of space. Separate guest quarters/studio, three bay car accom., workshop, town / tank water & garden shed complete the property. A wonderful opportunity to live on a large allotment so close to the town centre!

**Type** : House  
**Building Size** : 18 sqm  
**Land Size** : 9786 sqm  
**View** : <https://www.kennedyandhunt.com.au/sale/vic/macedon-ranges/gisborne/residential/house/5848615>

Garden Shed

RWT

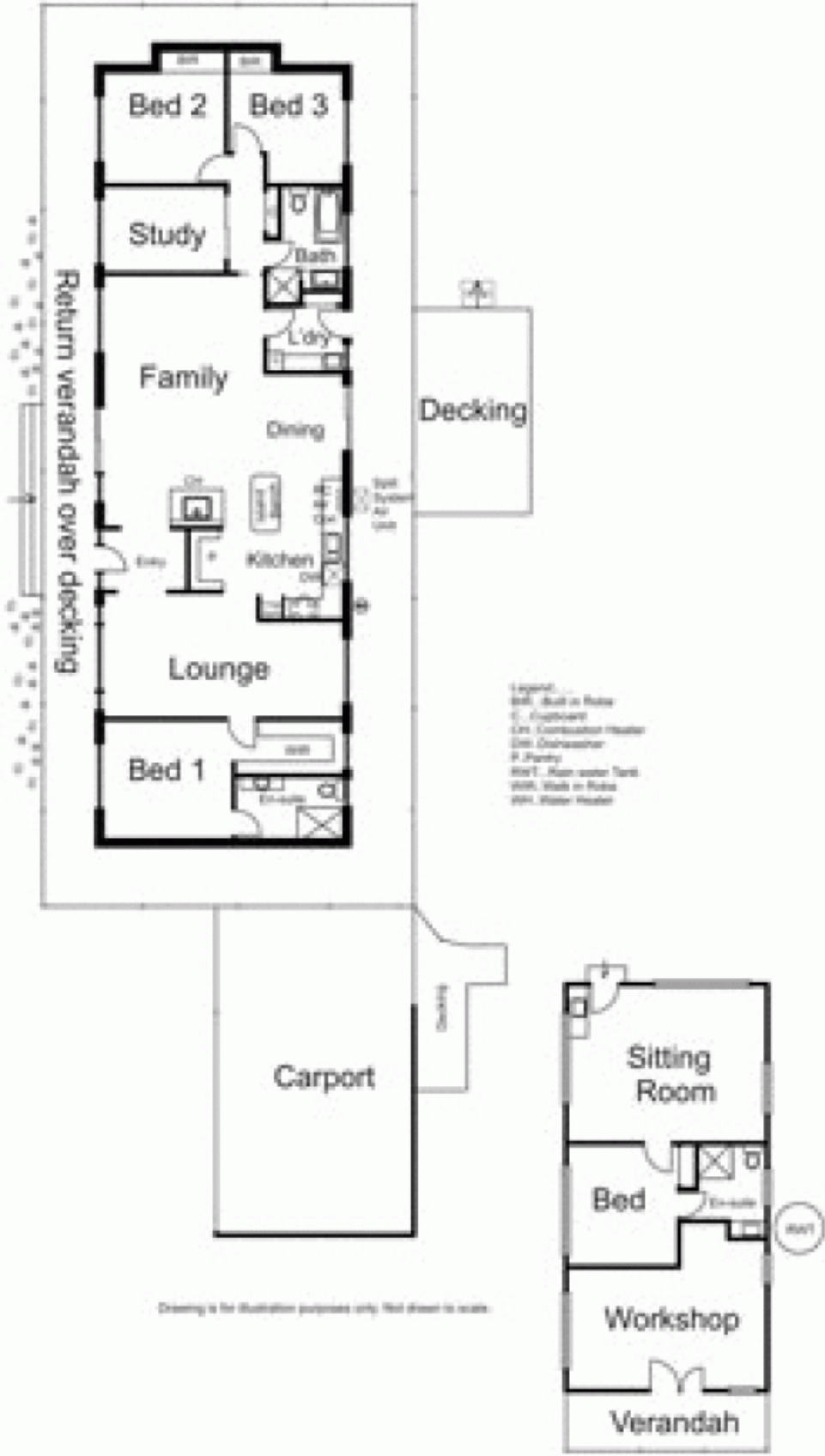

Drawing is for illustration purposes only. Not drawn to scale.