



6 Thompson Close GISBORNE VIC

3 2 2

Federation influenced home uses its charm to impress. User friendly floorplan consists of three bedrooms, Ensuite, lounge, study and expansive kitchen/meals/living area. This area opens to wonderful alfresco decking. The property has a practical rear yard along with the latest in Man land comforts! A comprehensive package that will be well received!

Type : House
Building Size : 22 sqm
Land Size : 948 sqm
View : <https://www.kennedyandhunt.com.au/sale/vic/macedon-ranges/gisborne/residential/house/5848646>

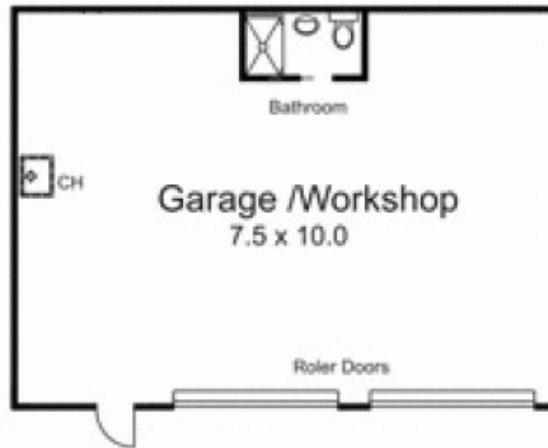

Garage / Workshop not in actual position to house.

Legend....
 BIR..Built in Robe
 CH..Combustion Heater
 DW..Dishwasher
 Fr Sp..Fridge Space
 P..Pantry
 WIR..Walk in Robe

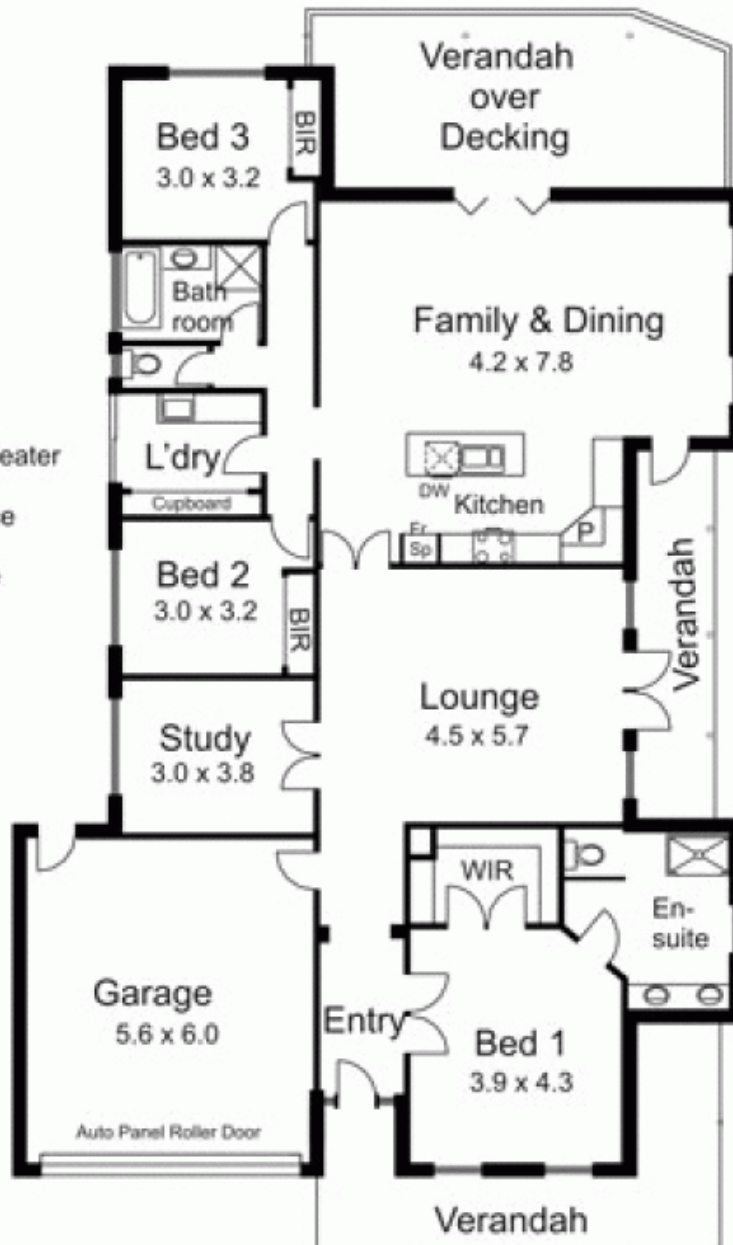

Drawing is for illustration purposes only. Not drawn to scale. All measurements are approximate only.