



102 Melton Road GISBORNE VIC

4 2 4

Yes, such a place does exist! Offers privacy, serenity, native wildlife, tennis court and self contained log cabin. Plus bright 4 bedroom brick veneer residence with two bathrooms & 2 living areas. Features brush box timber flooring and granite bench tops. Beautiful fenced lake with island, lilies and ducks. Easy walk to schools. Proposed Low Density Residential Zone.

Type : Acreage/Semi-Rural
Building Size : 21 sqm
Land Size : 16000 sqm
View : <https://www.kennedyandhunt.com.au/sale/vic/macedon-ranges/gisborne/residential/acreagesemirural/5848649>

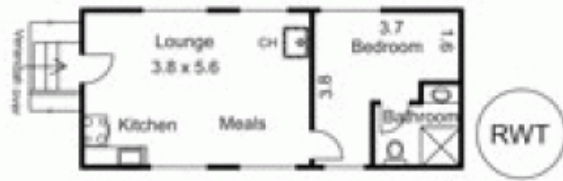

Log Cabin

Not in actual position to house



Drawing is for illustration purposes only. Not drawn to scale. All measurements are approximate only.