



35 Margaret Street MACEDON VIC

3  2  1 

Modern split level residence, conveniently positioned near shops, restaurants and railway station. Comprises 3 bedrooms, 2 bathrooms, spacious kitchen adjacent meals area, family room looking onto a colourful garden, lounge / dining. Carport. Investment opportunity or just move in.

Type : Townhouse
Building Size : 13 sqm
Land Size : 507 sqm
View : <https://www.kennedyandhunt.com.au/sale/vic/macedon-ranges/macedon/residential/townhouse/5848675>

Legend....
 BIR....Built in Robe
 Fr Sp....Fridge Space
 OV....Oven
 SS Air Con..Split System Air Conditioner
 SS Air Con Unit....Split System Air Conditioner Unit

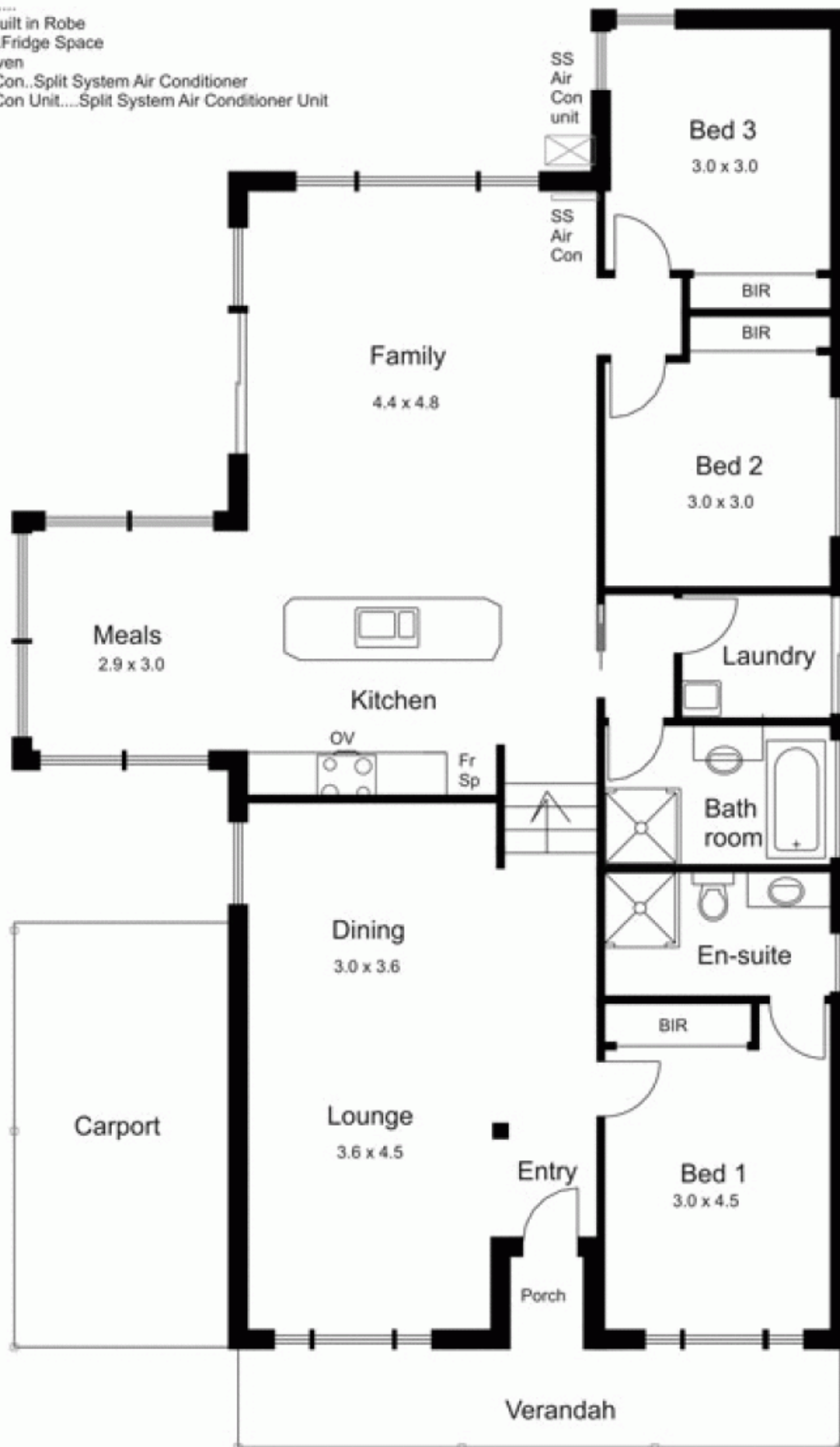

Drawing is for illustration purposes only. Not drawn to scale. All measurements are approximate only.