



6 Pindara Place GISBORNE VIC

4 2 2

Four bedrooms (two possible master suites), home office/gym or multi media room, separate lounge/dining, kitchen/meals/family, delightful breakfast indoor/outdoor room, scullery/laundry space, three way bathroom and ensuite. Many features include double glazing, steel frame, solar hot water, high ceilings, decking and sealed driveway. Fully integrated double garage. Landscaped gardens with impressive rock walling.

Type : House
Building Size : 24 sqm
Land Size : 964 sqm
View : <https://www.kennedyandhunt.com.au/sale/vic/macedon-ranges/gisborne/residential/house/5848691>

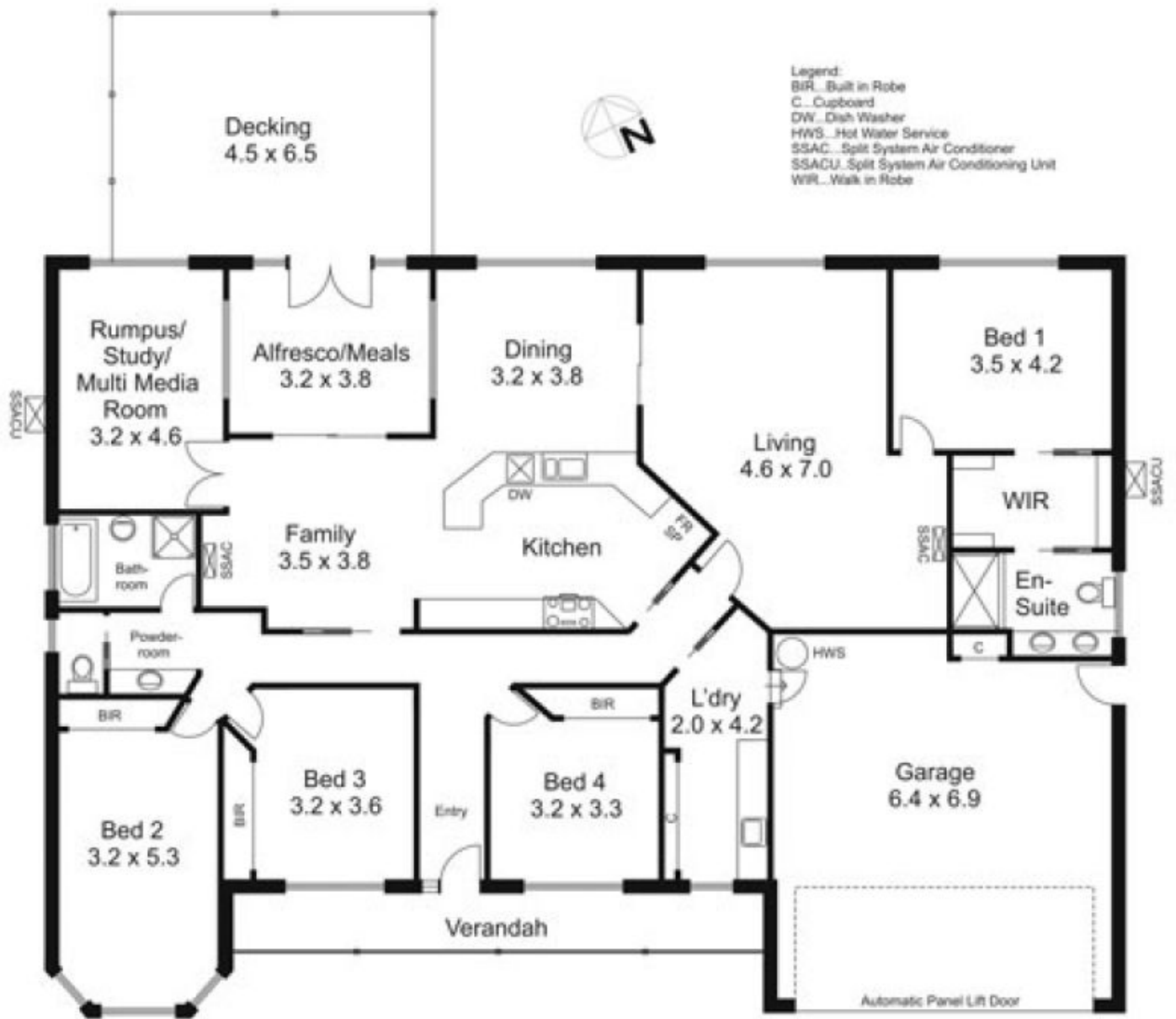

Drawing for illustration purposes only. Not drawn to scale. All measurements are approximate only.