



20 Woodworth Street NEW GISBORNE VIC

4 2 4

Take advantage at market entry level to purchase this four bedroom residence and add your own touch. Residence includes ensuite to main bedroom, recently installed kitchen with stainless steel appliances, family room and lounge/dining. Large decking off family room for the weekend barbeque, double garage carport and plenty of garden space.

Type : House
Building Size : 14 sqm
Land Size : 794 sqm
View : <https://www.kennedyandhunt.com.au/sale/vic/macedon-ranges/new-gisborne/residential/house/5848710>

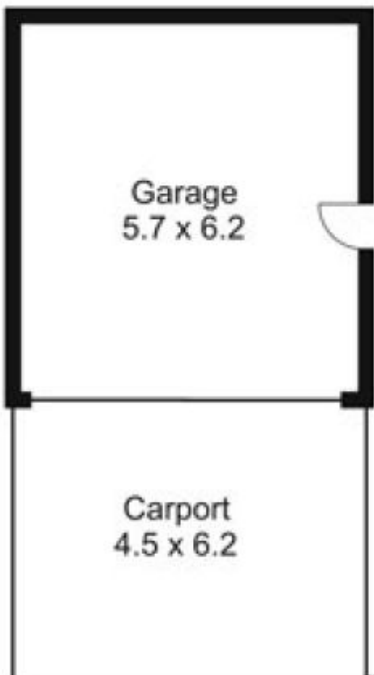

- Legend:
 BIR...Built in Robe
 C...Cupboard
 CH...Combustion Heater
 DW...Dish Washer
 FR SP...Fridge Space
 HWS...Hot Water Service
 WO...Wall Oven
 WTR...Walk Through Robe

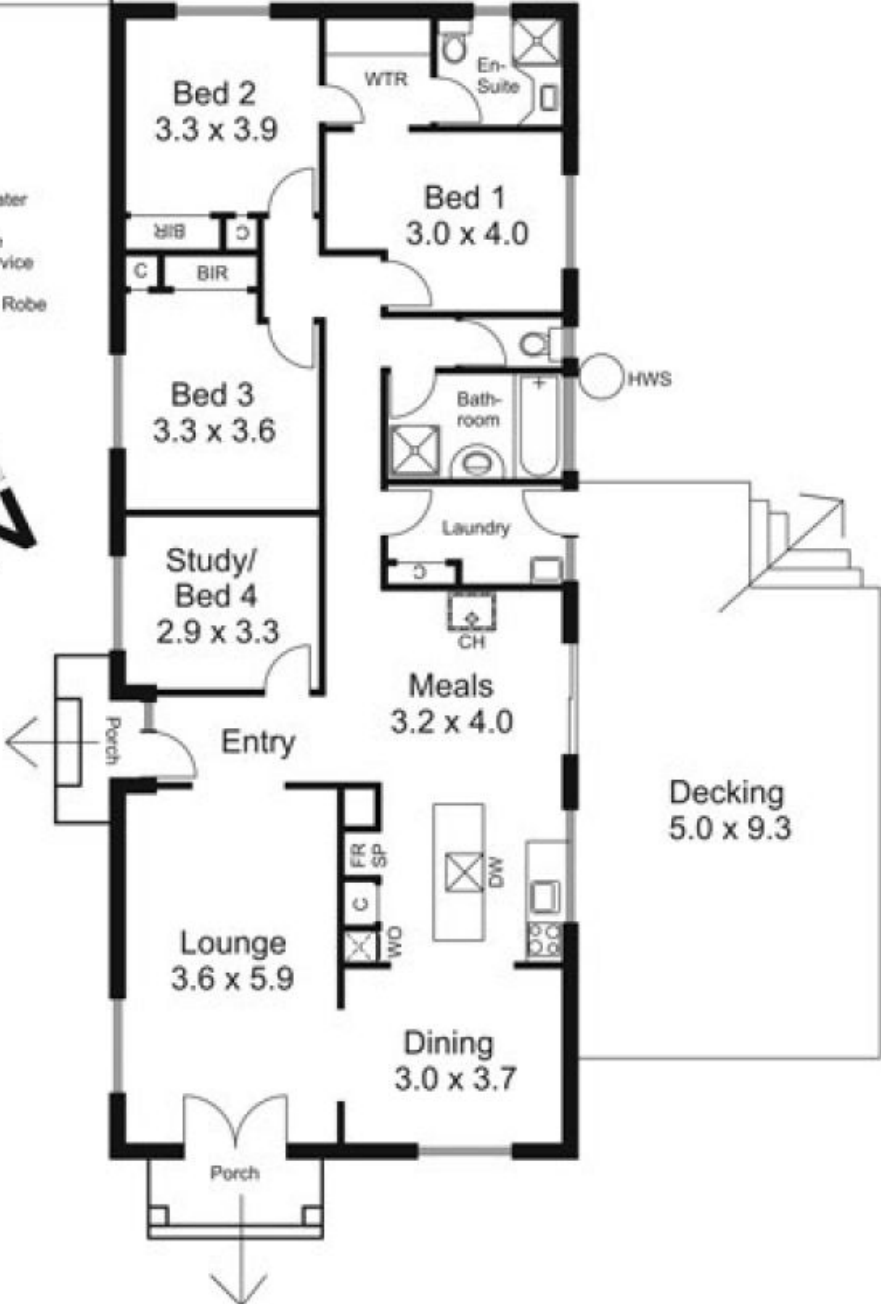

Drawing for illustration purposes only. Not down to scale. All measurements are approximate only.