



16 Jonathan Road GISBORNE VIC

4 2 3

Magnificent views to Mount Macedon set an enviable scene for this exceptional architect designed home. This distinctive home is constructed from rammed earth walls and comprises four bedrooms, master with ensuite, study, spacious open plan kitchen/dining/living area and second lounge or parents retreat!

Externally this property continues to impress. Two large covered decks for alfresco living - one of which can be enclosed with marine quality PVC blinds. The inground solar pool enhances these fantastic living spaces. The gently sloping block then extends down to an enclosed veggie garden, orchard and wonderful yabbie filled ornamental dam with jetty! No expense has been spared and this home has been maintained in that same standard.

Type : Acreage/Semi-Rural
Building Size : 25 sqm
Land Size : 6008 sqm
View : <https://www.kennedyandhunt.com.au/sale/vic/macedon-ranges/gisborne/residential/acreagesemirural/5848737>

[For full version visit the website](https://www.kennedyandhunt.com.au)

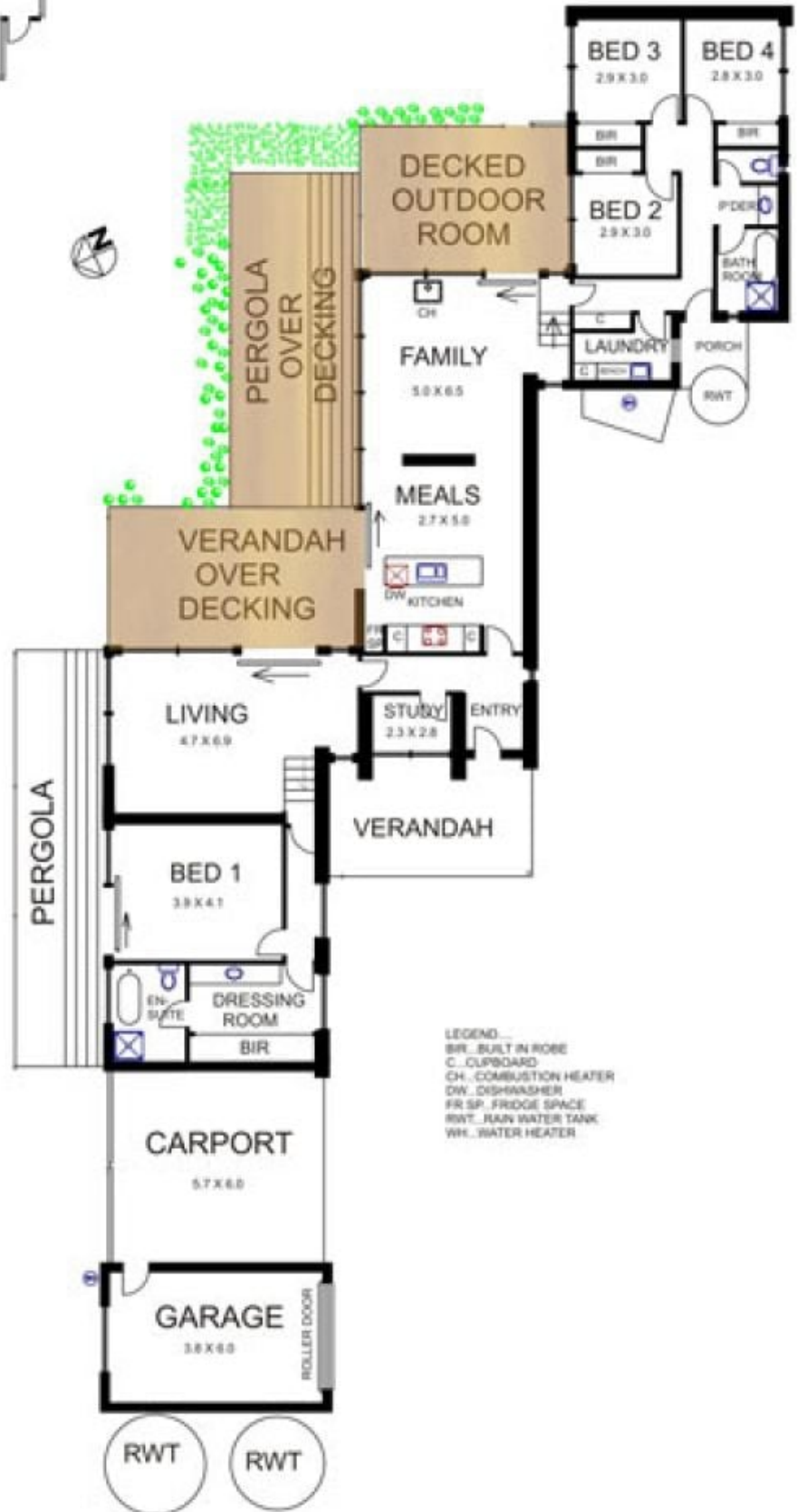
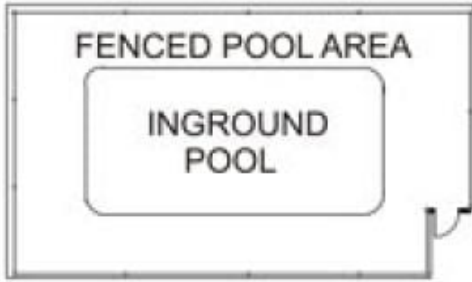

DRAWING IS FOR ILLUSTRATION PURPOSES ONLY NOT DRAWN TO SCALE.