

Auction
Saturday 21st of October at 2.30pm
unless sold prior



5 Misty View Court Gisborne VIC

5 🏠 3 🚗 5 🚗

Set in a tranquil location surrounded by executive properties, 5 Misty View Court presents the ideal combination of character and modern elegance on a large 1.27ha (approx.) allotment.

The home has been designed with a flexible floorplan that is readily adaptable to suit the needs of your family.

Incorporating 4 / 5 bedrooms, 3 living areas plus several options for a dedicated study - perfect for anyone looking to work from home.

Highlights include a heated inground pool, spacious alfresco / pergola area, and large shed / workshop - which complete this lifestyle property.

Imagine the family coming home to this delightful property

Price : \$ 1,750,000
Building Size : 27.77 sqm
Land Size : 3.148 Acres
View : <https://www.kennedyandhunt.com.au/sale/vic/macedon-ranges/gisborne/residential/house/7370424>



Jason Kennedy
03 5428 2544

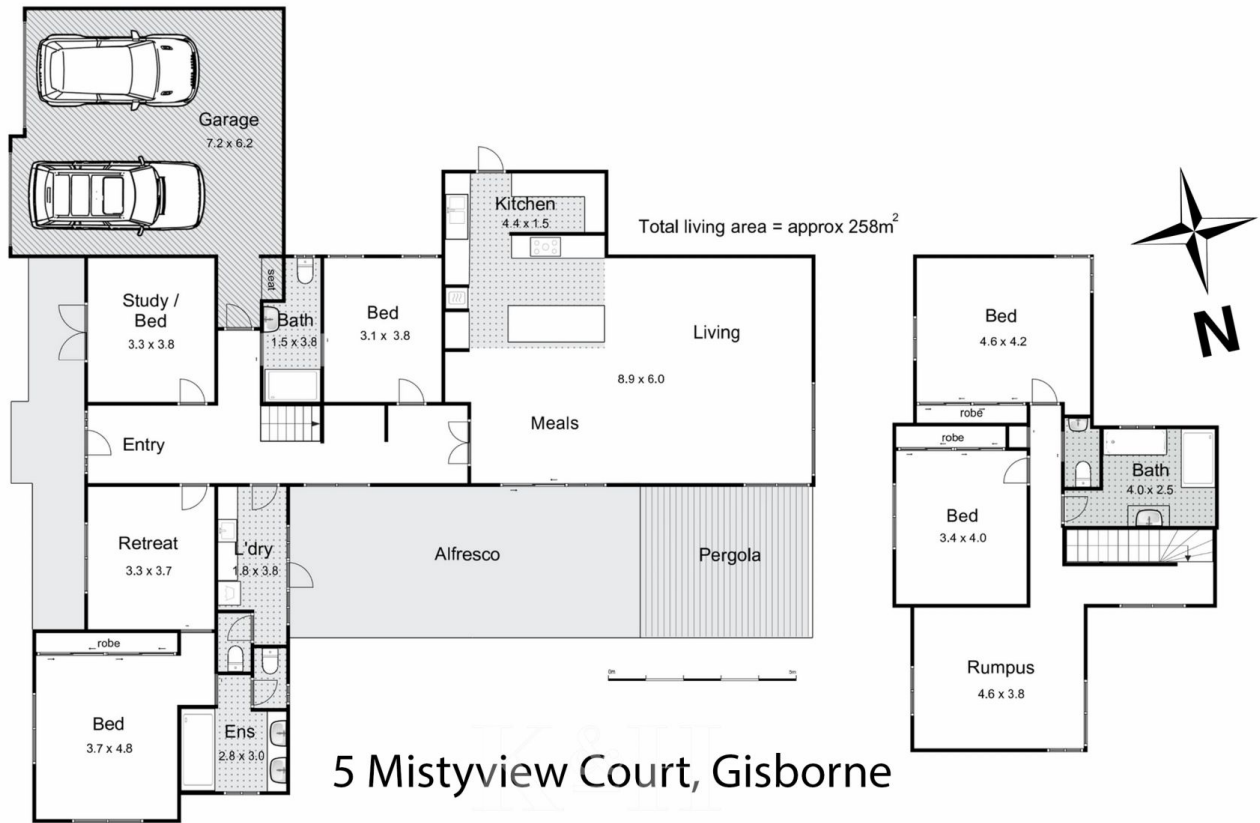

Whilst every attempt has been made to ensure the accuracy of the floor plan contained here, measurements of doors, windows, rooms and any other items are approximate and no responsibility is taken for any error, omission, or mis-statement. This plan is for illustrative purposes only and should be used as such by any prospective purchaser. The services, systems and appliances shown have not been tested and no guarantee as to their operability or efficiency can be given.