



251-271 Gisborne - Melton Road Toolern Vale VIC

4 🏠 2 🚗 2 🚗

This superior quality homestead, showcasing over 30 squares of internal living, offers a rare opportunity to live in your own tranquil lifestyle retreat, in a highly sought after and convenient location.

Superbly planned, the residence is sited to the rear of the lovely acreage, to ensure maximum privacy and allow full appreciation of the mesmerising city skyline.

Features of this substantial estate include:

- Entry via an automated gate and along a tree lined scoria driveway
- Striking entrance foyer to the home with timber, leadlight and stone highlights
- Grand, light filled lounge with open fireplace, and exceptional views to the city
- 4 spacious bedrooms

Price : \$ 2,330,000
Building Size : 282 sqm
Land Size : 11.09 ha
View : <https://www.kennedyandhunt.com.au/sale/vic/north-west/toolern-vale/residential/house/7483925>



Jason Kennedy
03 5428 2544

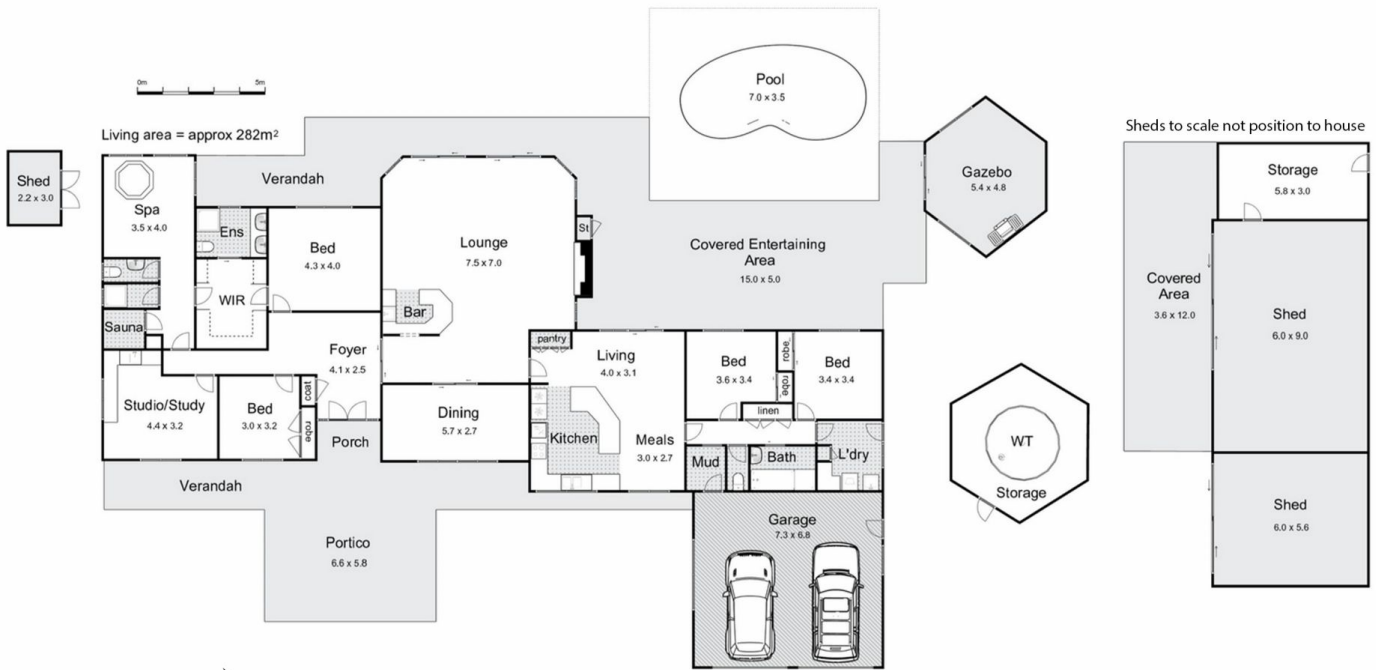

251-271 Gisborne-Melton Road, Toolern Vale

KENNEDY & BURNETT
 Kennedy & Burnett

Whilst every attempt has been made to ensure the accuracy of the floor plan contained here, measurements of doors, windows, rooms and any other items are approximate and no responsibility is taken for any error, omission, or mis-statement. This plan is for illustrative purposes only and should be used as such by any prospective purchaser. The services, systems and appliances shown have not been tested and no guarantee as to their operability or efficiency can be given.