



330 Barringo Road New Gisborne VIC

9 🏠 4 🚗 14 🚗

The sheer magnificence of "Highfield Estate" is evident from the moment you drive through the gated sandstone entrance.

With sweeping panoramic views of Mount Macedon and across the surrounding countryside, this spectacular estate presents an exceptionally rare opportunity to purchase a stunning 13.34 acre (approx.) rural lifestyle property that also offers established income streams:

- Highfield Reception with a current planning permit to build 10 accommodation units
- A delightful separate Chapel / Gallery
- Highfield Cottage, a charming second residence - currently operating as short-term accommodation

Type : Acreage/Semi-Rural
Land Size : 5.4 ha
View : <https://www.kennedyandhunt.com.au/sale/vic/macedon-ranges/new-gisborne/residential/acreagesemirural/7743640>



Jason Kennedy
03 5428 2544

[For full version visit the website](https://www.kennedyandhunt.com.au)



Whilst every attempt has been made to ensure the accuracy of the floor plan contained here, measurements of doors, windows, rooms and any other items are approximate and no responsibility is taken for any error, omission, or mis-statement. This plan is for illustrative purposes only and should be used as such by any prospective purchaser. The services, systems and appliances shown have not been tested and no guarantee as to their operability or efficiency can be given.

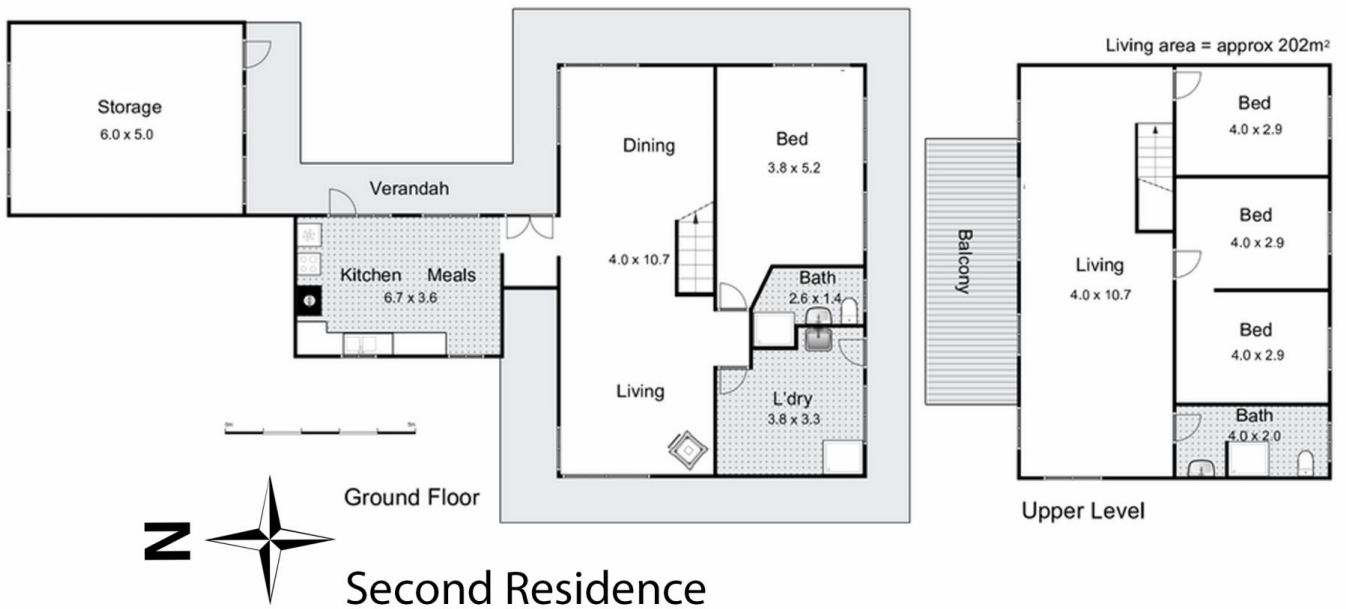

Whilst every attempt has been made to ensure the accuracy of the floor plan contained here, measurements of doors, windows, rooms and any other items are approximate and no responsibility is taken for any error, omission, or mis-statement. This plan is for illustrative purposes only and should be used as such by any prospective purchaser. The services, systems and appliances shown have not been tested and no guarantee as to their operability or efficiency can be given.

